





Working together to inspire your patients



Axis-D at a glance

	 Axis-D	 i-pen	 i-pen²	 Penlet	 Softpen
					
 Manual injection	●	●	●		
 Auto injection				●	●
 Reusable		●	●		●
 Disposable	●			●	
 Hidden needle				●	●
 Multiple injections	●	●	●	●	●
 Variable dosage	●	●	●		●
 Fixed dosage				●	

Axis-D Pen System

The Axis-D pen system is a disposable, variable dose injection device designed for the use with a 3 ml cartridge. The elegant and compact Axis-D pen system is available as a high quality plastic version with a large range of ergonomic options for an attractive and colorful design.



As awarded by The Chicago Athenaeum:
Museum of Architecture and Design.



The Axis-D pen system incorporates the following features:

- | | |
|---|---|
| ✓ Dose adjustment from 0.01 ml to 0.80 ml | ✓ Dose correction to avoid injection errors and loss of product |
| ✓ Customizable to alternative dose increments | ✓ Accurate dose reading with sliding window |
| ✓ Multiple injections | ✓ No rotating outer components during injection to prevent interference |
| ✓ Manual injection | |

Instructions for the use of Axis-D

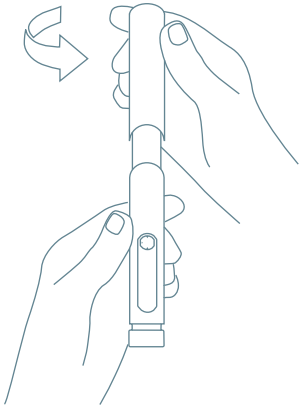

1 / Remove pen cap

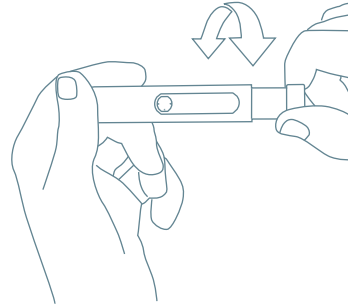

2 / Set dose

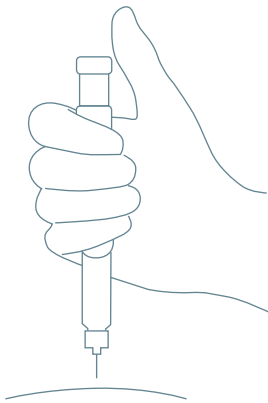

3 / Insert needle

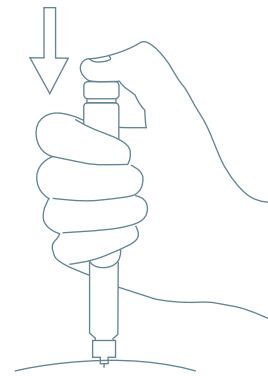

4 / Deliver dose

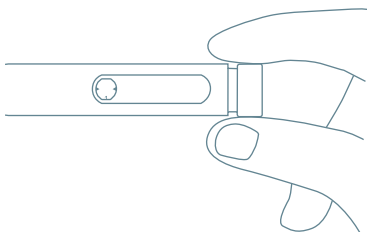

5 / Check display



Applications

Merck Serono Fertility Pen 1.0/1.1



As awarded by The Chicago Athenaeum:
Museum of Architecture and Design.

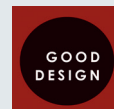

reddot design award

Pen Features



Developed exclusively for Merck Serono



Fertility treatment



For injection of specific MS hormones



Available in Europe, North America and ROW



User Focus

At Haselmeier our mission is to create products enabling a convenient and comfortable experience.

This is why patient feedback is integrated early in our device design.



Bridge to Market

At Haselmeier we provide integrated design, development and industrialization services to help you bridge your serial product into the market.



Manufacturing & LifeCycle Partner

Regardless of your requirements, Haselmeier applies the highest quality standard for manufacturing your drug delivery device to ensure a reliable and reproducible manufacturing and quality process.